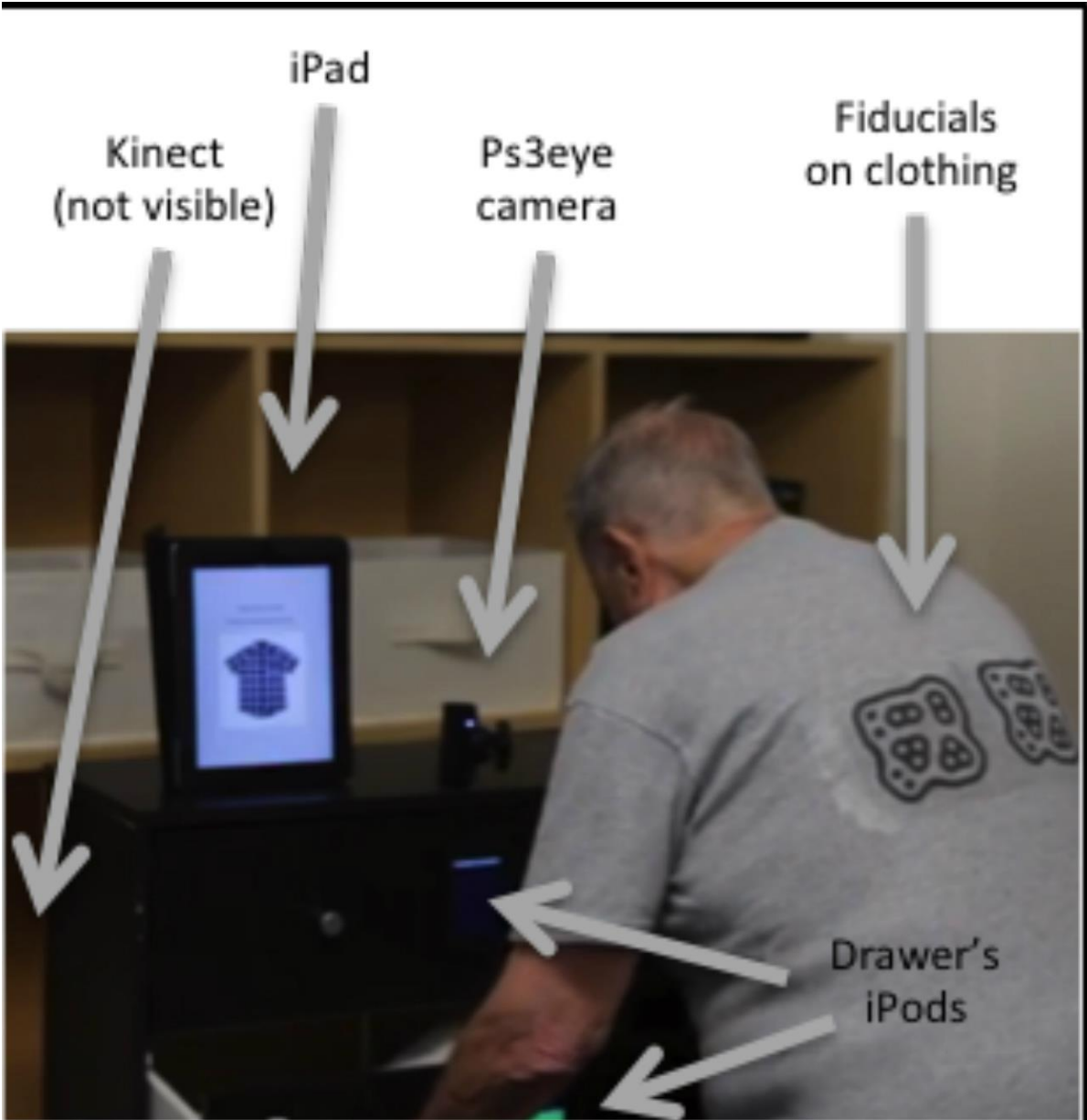

**Figure 1.** Typical human interaction with the DRESS system via an instrumented standard five-drawer dresser.



**Figure 2.** DRESS system architecture hardware and infrastructure.



**Figure 3.** Caregiver iOS mobile application user interface.

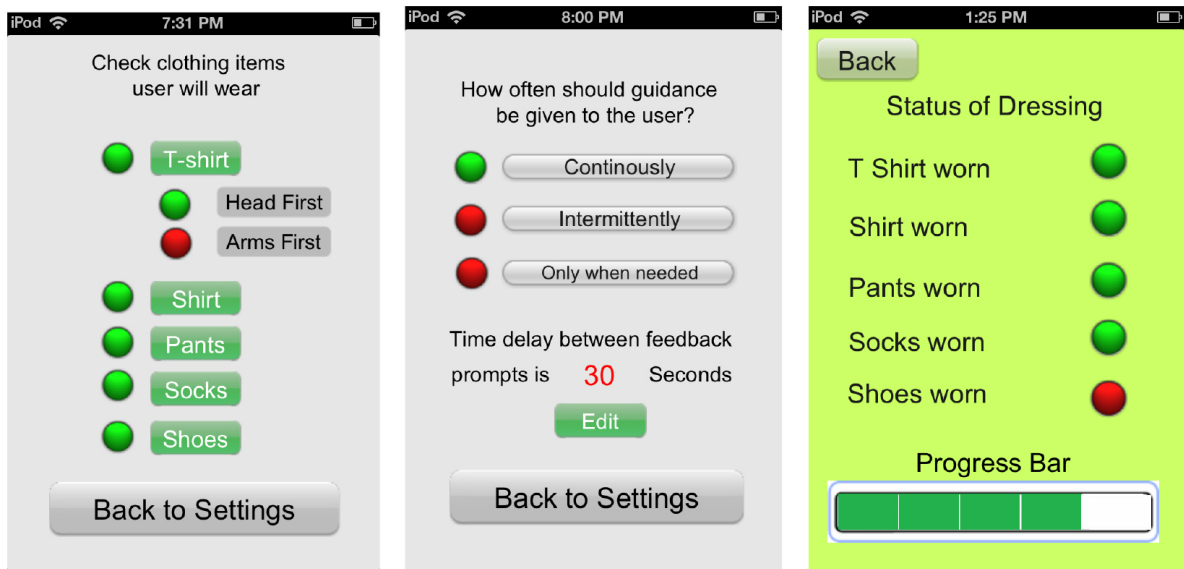

**Figure 4.** Example pictures of dressing conditions, “shirt misaligned” (left) and “pants partial” (right).

